



# Landscape Design

HTA Design



## HTA Design

HTA Design is an interdisciplinary practice renowned for designing some of the most influential housing projects and best places to live in the UK and internationally.

With around 250 professionals working across architecture, planning, masterplanning, landscape design, sustainability, interior design, wayfinding, and communications & engagement.

HTA has been at the forefront of housing innovation and sustainability for over 50 years.

We work from studios in London, Bristol, Edinburgh, Manchester, Nottingham and Sydney.

HTA has been recognised as a leading employer, winning AJ100 Practice of the Year in 2025 as well as AJ100 Employer of the Year in 2018, 2022, 2023, and 2024.

As a certified B Corporation, the practice demonstrates long term commitment to maintaining high standards of social and environmental performance, accountability and transparency.

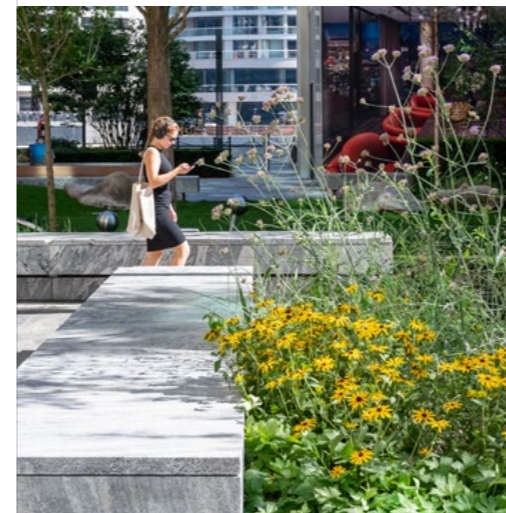
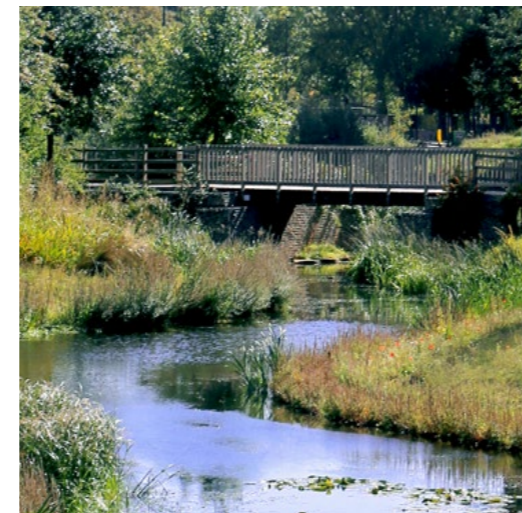



## The Team

HTA Landscape's philosophy is to respond to the distinct character of each place while embracing new and innovative urban and landscape forms. We prioritise creating environments that are deeply rooted in their context, respectful of cultural heritage, resilient, biodiverse, and designed to encourage social interaction.

We focus on the role landscape design plays in enhancing urban biodiversity, envisioning what parks of the future might look like, and prioritising conservation and rewilding in our work. With over 20 years of experience, our team continues to lead in parkland design, masterplanning, and sustainable placemaking.

### What we do:

- ↘ Urban regeneration & housing
- ↘ Heritage & visitor landscapes
- ↘ Parks & play
- ↘ Public realm design

### Who we are:

- ↘ Based across six studios
- ↘ Delivering projects at all workstages
- ↘ 45 landscape architects

# Awards

## Landscape Institute Awards

### Winner:

Sir David Attenborough Award for Enhancing Biodiversity, Cator Park (2020)

The President's Award, Cator Park (2020)

Excellence through Planting and Horticulture,

The Water Gardens (2019)

Conservation & Heritage, The Water Gardens (2017)

Conservation & Heritage, Stevenage Town Centre Gardens (2011)

Park Local Landscape Planning Award, Great Lines Heritage (2011)

### Finalist:

Excellence in Small Landscape & Garden Design, Eden Dock (2025)

Excellence in Biodiversity Conservation & Enhancement, The Paddock (2025)

Excellence in Place Regeneration, Claremont Park (2023)

Masterplanning & Public Realm, Aylesbury Estate (2016)

## The Pineapple Awards

### Winner:

Public Space, Eden Dock (2025)

Place in Progress, Claremont Park (2023)

### Finalist:

Union Square, Activation (2026)

Place in Progress, Greenford Quay (2025)

Future of Place, Dagenham Green (2023)

Public Realm, TwelveTrees Park (2023)

Public Space, Camley Street Natural Park (2023)

Public Place, South Quay Plaza (2022)

Place in Progress, Greenford Quay (2020)

## CTBUH Awards

### Winner:

Urban Habitat, Greenford Quay (2024)

## World Architecture Festival Awards

### Finalist:

Landscape & Public Realm, Eden Dock (2025)

## World Landscape Architecture Awards

### Honourable Mention:

Sustainability & Resilience, Eden Dock (2025)

## AJ Architecture Awards

### Finalist:

Landscape & Public Realm, Eden Dock (2025)

Landscape Architecture, Cator Park (2019)

## NLA Awards

### Winner:

Public Space, Claremont Park (2022)

### Highly Commended:

Placemaking, Cator Park (2020)

### Finalist:

Public Spaces, Eden Dock (2025)

Mayor's Prize, Eden Dock (2025)

Planning, Greenford Quay (2020)

## British Home Awards

### Winner:

Best Garden & Landscaping Design, South Quay Plaza (2022)

Best Garden & Landscaping Design, Cator Park (2021)

Judges' Award for Excellence, Cator Park (2021)

Best Placemaking, Kidbrooke Village (2019)

### Highly Commended:

Landscape Development, Saffron Square (2014)

## BD AYA Awards

### Winner:

Public Realm Architect of the Year (2019)

### Finalist:

Public Realm Architect of the Year (2021)

Public Realm Architect of the Year (2020)

Masterplanning & Public Realm Architect

of the Year (2018, 2017)

## BALI Awards

### Winner:

Hard Landscaping Construction over £500,000,

The Paddock (2025)

Regeneration Scheme over £500,000, Hoppa Play

and SkatePark (2025)

Commercial Roof Garden, South Quay Plaza (2021)

Best Landscape over £1.5m, Stevenage Town Centre

Gardens (2012)

## Civic Trust Awards

### Winner:

Eden Dock (2026)

## Building with Nature Awards

### Winner:

Sutton Estate (2022)

## Planning Awards

### Winner:

Regeneration of the Year, Grahame Park (2023)

Planning Permission of the Year, Dagenham Green (2023)

### Highly Commended:

Best use of Brownfield Land in Placemaking,

Dagenham Green (2023)

## Scottish Design Awards

### Finalist:

Masterplan, Greenford Quay (2023)

## Pro Landscaper Awards

### Winner:

International City Landscape Project, Eden Dock (2025)

Landscape Architecture Studio of the Year (2024)

### Finalist:

Residential Project over \$500k, South Quay Plaza (2025)

Industry Collaboration, HTA & Maylim (2022)

## RIBA Awards

### Highly Commended:

RIBA MacEwen Award: Eden Dock (2026)

### Shortlisted:

RIBA London East: Eden Dock (2026)





Eden Dock

## Eden Dock

London Borough of Tower Hamlets  
for Canary Wharf Group

HTA led the landscape design for Eden Dock, a 1.55 hectare public space in Canary Wharf that transforms a previously inaccessible 325 metre dock into a model of sustainable regeneration. Once ecologically barren, it is now open year round as a free destination that restores biodiversity and reconnects communities with nature. The project demonstrates how underused infrastructure can be adapted to support climate resilience, wellbeing and urban ecological repair.

Created in partnership with the Eden Project, the design brings people down to water level for the first time. Its most distinctive feature is the Floating Forest, a series of modular planted islands that form a soft, immersive edge to the dock. Inspired by wetland ecosystems, the islands create diverse habitats, echoing the structure of natural shorelines and floodplains. These planted platforms add visual richness, strengthen ecological networks and support wildlife above and below the water line.

Along the dock edge, boardwalks, bleacher seating and terraces create welcoming places to gather. Natural play features, including sandboxes and “mini worlds”, invite exploration, making Eden Dock a place where people can connect with each other and with nature. Ongoing monitoring will measure habitat success, biodiversity gains and ensure long term resilience.

HTA Landscape Design



Eden Dock



HTA Landscape Design

The planting features native vegetation that supports invertebrates, amphibians, fish and waterfowl. Fish refuges beneath the islands create spawning grounds, while bird boxes in trees provide nesting sites. Temporary fencing protects young plants, and purpose designed “duck doors” ensure safe access for wildlife.





Eden Dock



HTA Landscape Design

Eden Dock delivers a 55% Biodiversity Net Gain, supported by 770 sqm of native planted floating islands and 42 new trees. Planting includes 70 to 80 resilient species, improving year round habitat for pollinators, birds and aquatic life. Ecological performance is measured through reduced urban heat, carbon sequestration, and improved air and water quality. Together, these measures deliver a 100% uplift in predicted ecosystem service value.







## The Queen Elizabeth II Garden

Westminster City Council  
for The Royal Parks

Set within the Grade I registered historic landscape of Regent's Park, one of London's most cherished green spaces, a former plant nursery store yard has been transformed into a beautiful, biodiverse public garden of national significance. The garden serves as a lasting tribute to Her Late Majesty Queen Elizabeth II, celebrating her remarkable life, unwavering service, and lifelong commitment to environmental conservation.

The new garden delivers a huge boost to biodiversity in the form of hedgerows, trees, meadows, wildlife attracting plants and a new pond. Its planting is carefully selected for resilience to the UK's changing climate. Championing a circular economy, the project minimises waste, pollution, and environmental impact by re-using substantial demolition materials, including crushed concrete, brick, and steelwork, within the garden's design.

Conceived as a long-term landscape designed to evolve gradually over time, it is built to endure a changing climate and accommodate significant visitor numbers, ensuring future generations can continue to enjoy London's natural beauty and biodiversity.



The Queen Elizabeth II Garden



HTA Landscape Design



The Queen Elizabeth II Garden



HTA Landscape Design

The garden achieves a 184% Biodiversity Net Gain and is targeting an Excellent BREEAM Infrastructure rating. Through a carefully considered design, the project secured 80% reduction in embodied carbon compared with standard approaches. All uncontaminated soil is reused on site, and 100% of excavation, demolition and construction waste is diverted from landfill.





The Queen Elizabeth II Garden



HTA Landscape Design





## South Quay Plaza

London Borough of Tower Hamlets  
for Berkeley Homes

HTA Design led the public realm and landscape design for South Quay Plaza, a major residential-led development by Berkeley Homes, located on the Isle of Dogs. The site, masterplanned by Foster + Partners, includes three of the UK's tallest residential mixed use towers.

HTA's landscape team reshaped the masterplan to reduce building footprints and relocate servicing below ground, reclaiming over two-thirds of the site as car-free public space.

Since 2015, the team has delivered 1.2 hectares of public realm, including biodiverse parkland, waterside gardens and over 320 mature trees, achieving a 500% Biodiversity Net Gain. New pedestrian and cycle routes reconnect the area to its surroundings, improving links across the Isle of Dogs.

In contrast to the dense urban context, the landscape creates a calm setting at the base of the towers. A sequence of gardens framed by trees offers visual variety and a high level of amenity, including dedicated play areas, spaces to sit, stroll, and meet neighbours.

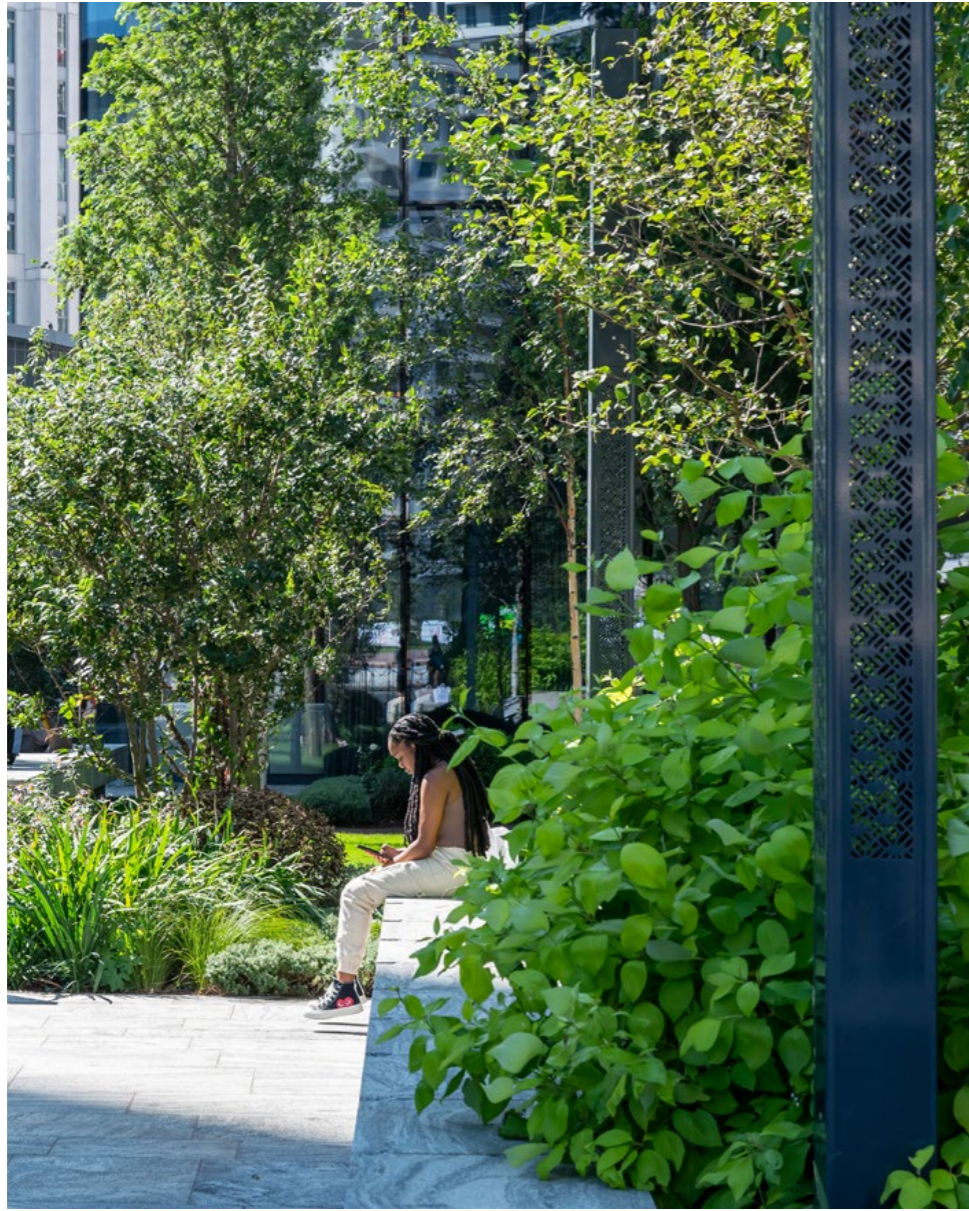

South Quay Plaza



HTA Landscape Design

The latest tower, designed by Foster + Partners, features landscaped terraces that create three themed communal spaces appearing as green ribbons along the façade, with tree planting on all elevations.

The Bamboo Sanctuary on Level 18 incorporates an outdoor spa, while the iGarden on Level 37 provides outdoor workspaces. On Level 55, the Sky Meadow offers social and relaxation areas with panoramic views.





South Quay Plaza



HTA Landscape Design





## Crystal Palace Park

London Borough of Bromley  
for Bromley Council and Crystal Palace Trust

The London Borough of Bromley has appointed HTA Design as lead consultant and landscape architect for the first phase of the Crystal Palace Park Regeneration Plan. Working with a multidisciplinary team of 20 specialist consultants, we are leading the project from concept through to detailed design and construction.

The regeneration restores the Geological Court and Italian Terraces while creating a park that is inclusive, biodiverse, climate resilient and adaptable for events and community use. New facilities include a dinosaur themed play area, visitor centre, heritage trails and reinstating the Grand Centre Walk as a landmark gateway.

Our proposals for the Geological Court, developed with Historic England, will restore 30 Grade I listed dinosaur sculptures and 14 geological illustrations, removing layers of vegetation and sediment to reveal Paxton's original vision. Paleo inspired planting and new rock formations will revive the Victorian sense of wonder.

The Italian Terraces will be repaired and replanted with biodiverse meadows and species rich grassland. Sustainability underpins the design, reusing site won soil, repurposing lake silt to create habitats and minimising imported materials.



Crystal Palace Park



HTA Landscape Design





Crystal Palace Park



HTA Landscape Design



Crystal Palace Park



HTA Landscape Design



## Cator Park

Royal Borough of Greenwich  
for Berkeley Homes

Cator Park in Kidbrooke Village has been transformed into an 8 hectare landscape that combines rewilding, play and biodiversity to create a park for people and nature. The project forms part of a 30 year estate regeneration programme, turning underused open space into a biodiverse, climate resilient park.

Working with the London Wildlife Trust and a team of specialists, we remodelled the site to introduce a rich habitat mosaic alongside a sculptural play space that acts as a destination for families. New routes create corridors for both wildlife and people, improving ecological connectivity and encouraging active use throughout the neighbourhood.

Soils recovered on site were reused to reduce waste, while wetland systems naturally manage water and mitigate flood risk. Planting was selected to adapt to a changing climate and provide long term ecological benefit.

Cator Park has been recognised with national awards for its contribution to biodiversity and community wellbeing, including the Sir David Attenborough Award for Enhancing Biodiversity.



Cator Park



HTA Landscape Design

Cator Park delivers a 185% Biodiversity Net Gain, supported by wetlands, meadows and species rich grassland. A key feature is a 3,000 sqm biophilic playground, inspired by 'the brook over which kites fly' and created in collaboration with Apes Play. Rainwater is managed through landscape-led features that improve site performance and resilience.





Cator Park



HTA Landscape Design





## Claremont Park

Brent Cross  
for Related Argent

Claremont Park has been redesigned to bring new life to an established open space, creating a park where the local community can relax, be active, socialise and connect with nature. The design combines green space, imaginative play facilities, a new pond, nature trails and a family run kiosk, alongside the planting of more than 300 new trees.

The landscape strategy strengthens the park's ecological value by introducing biodiverse meadows, pollinator friendly planting and wetlands that support local wildlife. A new pond and water features add to the habitat mix while creating playful, sensory experiences for visitors. Tree planting improves shade and microclimate, helping to build resilience to hotter summers and wetter winters.

An adventure play area encourages children of all ages to explore, with natural play structures, climbing frames and water play integrated into the landscape. Accessible paths, seating and open lawns provide spaces for walking, running and gathering, ensuring the park supports both everyday use and programmed community events.



Claremont Park



HTA Landscape Design



Claremont Park



HTA Landscape Design



Claremont Park



HTA Landscape Design





## Greenford Quay

London Borough of Ealing  
for Greystar and Tide

HTA Design led the landscape and public realm design for Greenford Quay, an exemplar regeneration project delivering 2,118 homes alongside commercial and community spaces. The scheme transforms former industrial land and brings new life to a previously inaccessible stretch of the Grand Union Canal.

The neighbourhood restores local connections with a new pedestrian footbridge across the canal and provides 17,650 sqm of commercial and retail space, including shops, restaurants and workspaces.

The 27 hectare site offers a network of connected spaces for people to gather, play and relax beside the water. A central plaza with dancing fountains supports cultural activity, drawing residents and visitors together and offering a playful water space in summer. A nature rich landscape and amphitheatre along the restored canal banks are already popular community destinations.

The revitalised landscape supports health and wellbeing while contributing to the wider regeneration of Ealing. By welcoming people back to the area, the development reconnects the community to the Grand Union Canal. Former routes across the site have been re-established, and a historic link to central London has reopened for cyclists and pedestrians.



Greenford Quay



HTA Landscape Design

Greenford Quay includes 3,000 sqm of meadow planting that supports biodiversity. More than eight green podium gardens provide habitats for local wildlife and outdoor spaces for residents. 370 new trees are being planted to improve shade, air quality and urban cooling. 40% of the masterplan is designed as green public open space, creating an accessible and generous landscape for the neighbourhood.





Each building in the Greenford Quay masterplan includes private outdoor space, providing residents with places for relaxation and everyday use. Complementing this, the development features roof terraces and shared landscape spaces designed as versatile environments where residents can socialise, exercise and unwind.



Greenford Quay

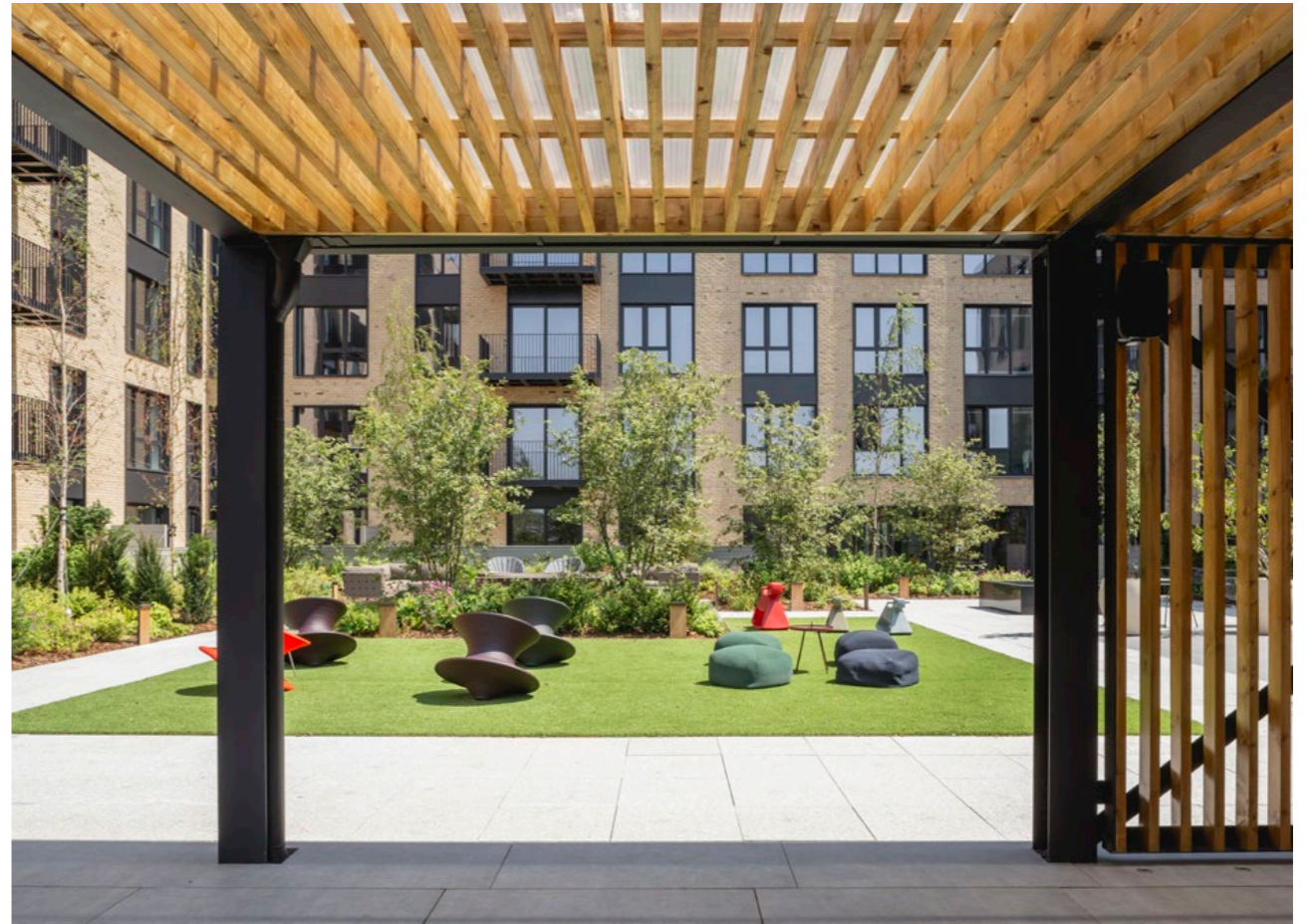

HTA Landscape Design



JILLERMAN'S



## 3 & 15 West Lane

Wood Wharf  
for Canary Wharf Group

Designed for Canary Wharf Group and Vertus, 3 and 15 West Lane deliver 297 aparthotel studios with shared amenities, active ground floor uses and surrounding public realm. Located within The Lanes, part of the 9 hectare Wood Wharf masterplan, the buildings sit in a car free neighbourhood defined by independent shops, pocket parks and pedestrian streets designed for year round activity.

HTA Design led the landscape design around 3 and 15 West Lane to support year round activity, provide public spaces for diverse uses, and contribute to biodiversity, wellbeing and the evolving character of Wood Wharf.

At its centre, Union Square is a flexible, multi use public space with a hard surfaced area for exhibitions and seasonal events. This is framed by planted edges, timber decking and places to sit and gather. To the north, an informal play space sits within naturalistic planting and a gently undulating landscape.

As part of the growing public realm in Canary Wharf, Union Square now hosts markets, performances, art installations and everyday moments of interaction.



3 & 15 West Lane



HTA Landscape Design

Planting defines the layout of the square, softening edges and framing routes through the space. Trees are selected for seasonal interest and shade, while beds combine ornamental and shade tolerant species with understory mixes that support biodiversity. Several pedestrian routes cross the square to improve access through the neighbourhood and create long views across Canary Wharf.





3 & 15 West Lane



HTA Landscape Design



3 & 15 West Lane



HTA Landscape Design



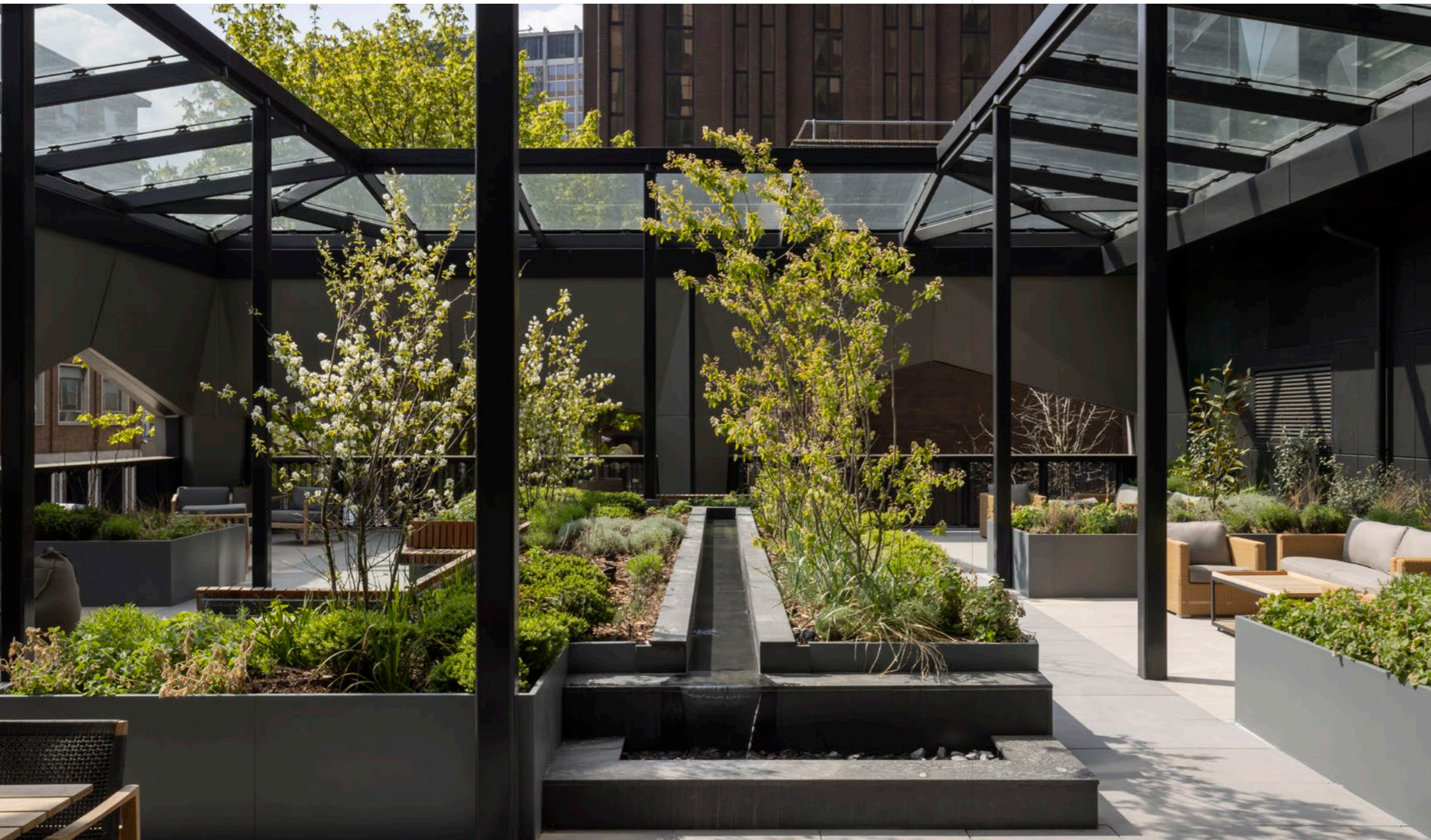

## Ten Degrees

London Borough of Croydon  
for Tide and Greystar

The landscape design for Ten Degrees connects the new public realm to key local landmarks, including East Croydon station, George Street and Park Hill Park. New tree and shrub planting establishes a green corridor with seating and a cycle route, creating a more accessible and welcoming approach.

The development includes a mezzanine garden and a series of roof terraces that extend the landscape above street level. In the mezzanine garden, raised planters, specimen trees and water features create outdoor rooms for dining, relaxation and socialising. On the upper levels, roof terraces provide outdoor lounges with panoramic city views. These spaces are designed for flexibility, supporting resident events such as outdoor yoga while offering everyday opportunities to connect with nature.



## The Water Gardens

Hertfordshire  
for Dacorum Borough Council

The Water Gardens represent one of the finest examples of post-war modernist landscape design in the UK. Designed by renowned landscape architect Geoffrey Jellicoe, they were added to the Register of Parks and Gardens of Special Historic Interest by English Heritage in 2010.

HTA Design led the restoration of the gardens, ensuring Jellicoe's original design intent was preserved. The space was adapted to meet contemporary needs, including improved accessibility, enhanced biodiversity and long term management.

The project has created a rejuvenated park that combines sculpted lawns, rich planting and a serpentine woodland walk along the River Gade. At its centre, the restored flower garden features massed roses and perennials arranged in a formal grid of beds, carefully echoing Jellicoe's composition.

The gardens reopened to the public in summer 2017, offering a renewed space for everyday use and securing the future of this rare and significant example of 20th century landscape design.



The Water Gardens



HTA Landscape Design



The Water Gardens



HTA Landscape Design





## Sutton Estate

Royal Borough of Kensington and Chelsea  
for Clarion Housing Group

HTA Design led the renovation of Sutton Estate in Chelsea, transforming four residential blocks within this 100 year old social housing development for Clarion Housing Group. The project delivers sustainable, affordable homes while conserving the Edwardian Baroque character established in 1913.

The landscape achieves a 40% Biodiversity Net Gain and a 59% increase in hedgerow planting, far exceeding the national 10% target. These results, calculated using DEFRA's Biodiversity Metric, reflect a detailed, place specific approach to urban ecology.

Hard surfaces have been replaced with a network of biodiverse and multifunctional green spaces. Pollinator meadows, edible planting, native species and green roofs are combined with sustainable drainage features to support people and wildlife.

Sutton Estate has been awarded Building with Nature accreditation, the first in London, recognising the importance of diverse planting and measurable biodiversity gain in a dense urban setting.



Sutton Estate



HTA Landscape Design

New communal landscapes include play streets, shared courtyards and the reimagined Sunken Garden, known locally as the Residents' Garden. A longstanding community initiative, the garden has been in active use for more than a decade and is now secured for the long term through the masterplan. Together, these spaces encourage social activity and create a healthier, greener public realm across the estate.







## Aylesbury Estate

London Borough of Southwark  
for Notting Hill Genesis

The Aylesbury Estate masterplan is one of London's largest estate regeneration projects, delivering 3,647 mixed tenure homes.

The landscape strategy creates green and fully integrated part of the city. The public realm features legible streets prioritising pedestrians and cyclists, connected by a network of linked open spaces. Parks, squares and gardens are arranged in a varied pattern, each with its own character and identity. Hard landscaped areas support civic activity, offering places to pause, meet and gather, while the wider green network strengthens connections with the surrounding neighbourhood and beyond.

HTA Design is lead designer for the first phase, working alongside Hawkins Brown and Mae Architects. This phase includes Plot 18 with the new Aylesbury Square. Framed by new housing, the square accommodates a medical centre designed by Morris+Company, library, nursery, café and 122 new homes across two buildings.



Aylesbury Estate



HTA Landscape Design

Aylesbury Square is a central space for the community, designed to support both programmed activity and informal use. Generous public realm, active ground floor frontages and clearly defined routes create an environment where people can meet, spend time or pass through comfortably.

The landscape responds to its context, stepping down from the taller blocks on Thurlow Street to the neighbouring conservation area. Planting, surfaces and spatial organisation reflect these shifts, defining edges while maintaining openness and visibility across the site.

Extensive consultation shaped the design, with residents, future occupants and local organisations influencing key details. Input from older residents guided the provision of seating and shade, while families helped shape access to the nursery and library. The result is a robust and legible public realm that balances social and ecological value while serving the community long into the future.





Aylesbury Estate



HTA Landscape Design



## TwelveTrees Park

London Borough of Newham  
for Berkeley Homes

TwelveTrees Park is a major mixed use regeneration project on an 11 hectare former Parcelforce depot beside the River Lea, south of the Olympic Park. The first phase delivers 1,080 of the 3,800 new homes planned across the wider masterplan, along with new public spaces, amenities, and a fully accessible entrance to West Ham station that connects directly into the site.

At its centre is a paved plaza defined by stepped terraces that double as amphitheatre style seating. A cascading water feature flows from an elevated pool to ground level jets, introducing movement and sound to the plaza while referencing the nearby River Lea.

Alongside the plaza and public park, the development includes a series of shared and private amenity gardens located on podiums and terraces throughout the residential blocks. These spaces provide residents with direct access to outdoor areas, including open lawns, seasonal planting, pergolas, seating areas, and informal play spaces. South facing terraces maximise sunlight, while tree planting and defined edges create privacy and shelter.



TwelveTrees Park



HTA Landscape Design



TwelveTrees Park

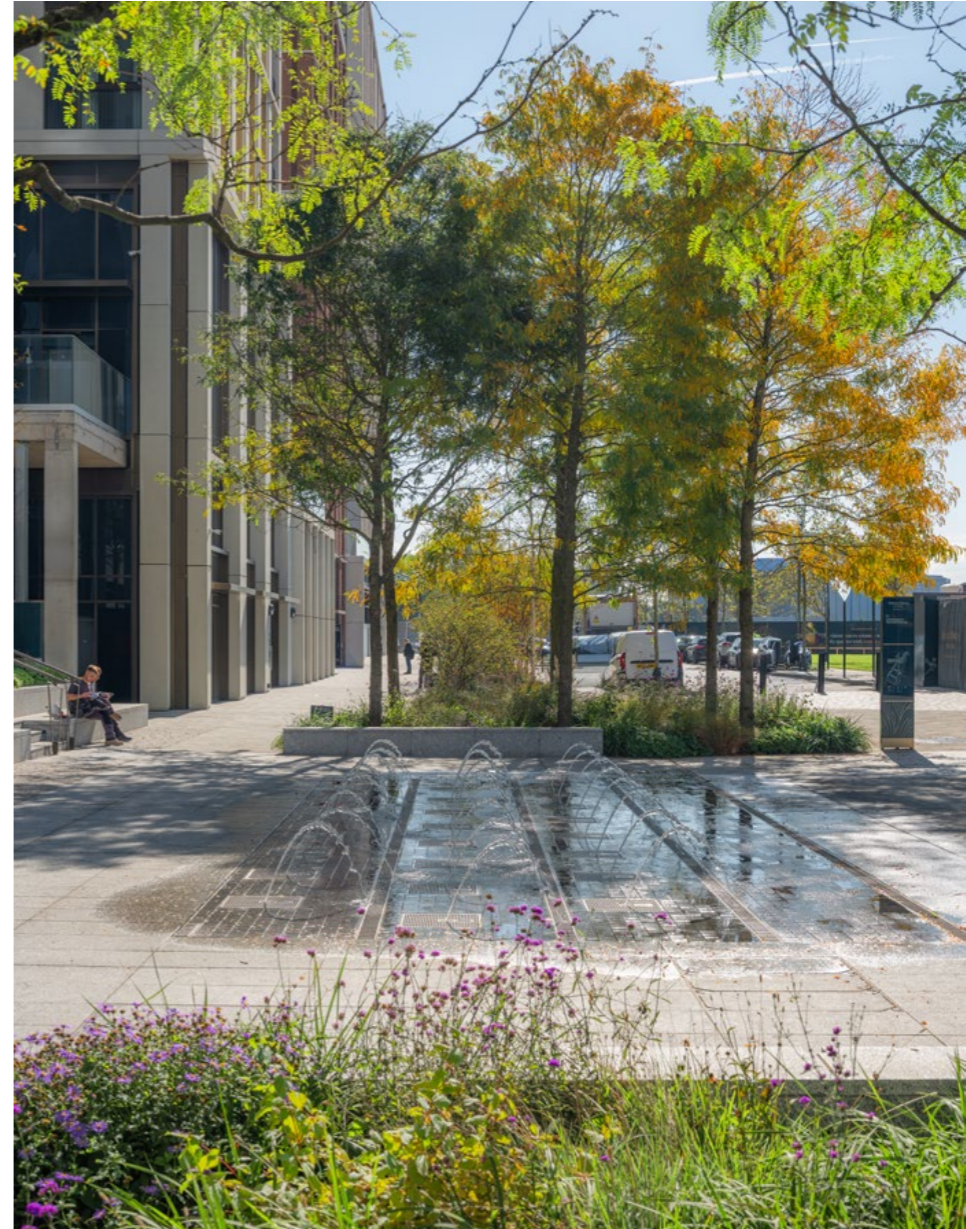

HTA Landscape Design



## Next Wave Bexhill

East Sussex  
for Rother District Council

The redesigned seafront and public realm surrounding the Grade I listed De La Warr Pavilion has played a key role in the wider regeneration of this Edwardian coastal town. HTA Design's landscape improves accessibility, supports biodiversity and creates welcoming spaces for both residents and visitors.

The promenade has been reimaged as a biodiverse linear park that is adaptable, informative and low maintenance. Planting is central to the design, with carefully selected species that enrich the visitor experience while supporting ecological value.

New spaces replace a once repetitive landscape with areas for shelter, seating, picnics, viewing, play and rest. Garden rooms and resting points encourage people to linger, bespoke benches designed for Bexhill add local character, and a sunbathing garden with windbreaks provides comfort on the exposed coast.

The project was Highly Commended at the Landscape Institute's Award for design under one hectare in 2012. Judges described it as "a simple yet beautifully designed waterfront space" and praised the planting process as best practice.



Next Wave Bexhill



HTA Landscape Design

The public realm is designed to support year round activity, from large scale events like the Concours of Elegance motor festival to seasonal programmes and off season markets. These uses help sustain the local economy and ensure the seafront remains active and welcoming throughout the year.







## Stevenage Town Centre Gardens

Hertfordshire  
for Stevenage Borough Council

The Town Centre Gardens were designed as an integral part of the post war masterplan for Stevenage, the UK's first New Town. Constructed between 1959 and 1961, they were the work of Gordon Patterson, the landscape architect appointed to help realise the town's ambition for green and accessible civic spaces.

Situated within the central civic and retail area, the gardens offer everyday amenity for residents, office workers and shoppers. The layout comprises two expansive green spaces with a lake, sensory gardens, a children's play area, civic artworks and a rich variety of tree and shrub planting.

The landscape design builds on this legacy, respecting the original design intent while enhancing biodiversity, restoring key features and reimagining the gardens as a contemporary public asset for the next generation.



Stevenage Town Centre Gardens

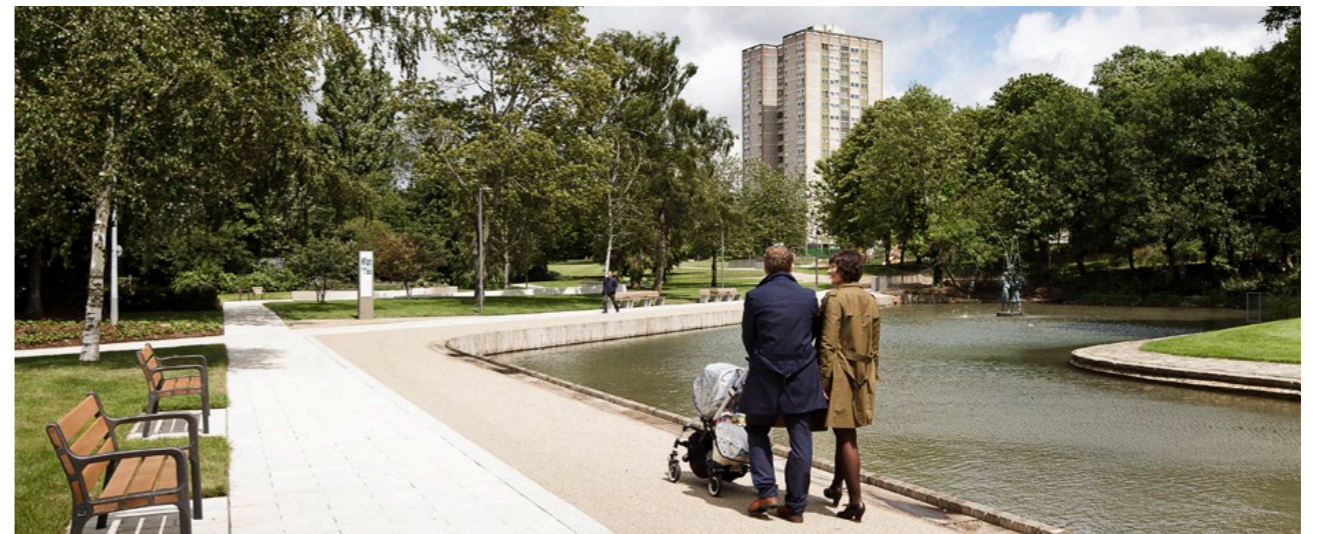

HTA Landscape Design





## The Paddock

Chatham  
for Medway Council

HTA Design led the transformation of The Paddock, a central green space in Chatham, into a biodiverse public garden that reconnects the town centre with its heritage and waterfront. The project represents a major step in Medway's approach to sustainability and landscape-led regeneration.

Working with horticulturalist Noel Kingsbury, HTA developed a planting scheme introducing more than 2,000 sqm of resilient, low maintenance and wildlife rich habitats. The design replaces formal grass areas with textured, seasonal and drought tolerant planting, creating an inviting and ecologically valuable setting. New paths reinstate historic connections between Chatham High Street, Fort Amherst and the waterfront, improving accessibility and legibility across the town centre.

Sheltered seating, a small amphitheatre and a reinterpreted pleasure garden layout provide space for rest, conversation and community activity. A large engraved map feature celebrates Chatham's military heritage, while sustainable drainage and new tree planting improve climate resilience.



The Paddock



HTA Landscape Design



The Paddock



HTA Landscape Design



## Hanham Hall

Bristol  
for Barratt Homes

Completed in 2013, Hanham Hall is England's first large scale volume housebuilder scheme to meet the zero carbon standards. HTA Design led the landscape design, embedding ecological function and community use at the core of the scheme.

A central green spine connects species rich wildflower meadows with hedgerows and the surrounding countryside. This corridor enhances biodiversity and movement for birds, bats and pollinators, supported by extensive native planting, orchard trees and habitat features such as bat boxes.

Sustainable drainage systems, including swales and attenuation ponds, manage rainfall while providing seasonal interest and supporting local wildlife. More than 150 semi mature trees were planted throughout the public realm and shared courtyards.

Drawing on the site's agricultural history, the landscape creates a resilient and biodiverse setting that supports wellbeing and connection to place.



The landscape is structured around a series of characterful communal spaces, from informal gardens to more formal mews, offering a variety of settings for rest, play and social interaction. Pedestrian and cycle routes thread through the site, encouraging active lifestyles and providing safe, direct connections across the neighbourhood.





Hanham Hall



HTA Landscape Design

We returned to Hanham Hall to carry out Post Occupancy Evaluation, speaking with residents about life in the neighbourhood. Among them is Holly, an artist who has lived at Hanham Hall for several years. She described how the landscape and sense of community influence both her daily life and her creative work.

Holly explained that the changing seasons, wildlife and patterns of light across the site have become recurring themes in her painting. She said that living at Hanham Hall has deepened her understanding of how design can bring people together through the simple details of shared gardens, walkable streets and visible green infrastructure. She spoke of the balance between private space and community life, where allotments, green corridors and regular encounters make daily life feel open and connected. “That’s one of the things I love about living here,” she said, “you always see familiar faces, and people look out for each other.”







Hanham Hall



HTA Landscape Design





## Cane Hill

London Borough of Croydon  
for Barratt Homes

HTA Design led the landscape and masterplan design for Cane Hill, creating a neighbourhood that balances new housing with extensive public open space, supporting biodiversity, access to nature and long term environmental resilience.

Covering 35 hectares, Cane Hill delivers around 675 new homes set within a landscape where more than half the site is dedicated to green infrastructure. At its centre lies a country park that provides the principal organising feature for the masterplan, shaped around the site's existing woodland, hedgerows and mature trees.

Ecological enhancements include extensive native planting, wildflower meadows and new wetland habitats integrated into the sustainable drainage design. Together these elements create a coherent and characterful landscape that reflects the site's natural and historic setting.



Cane Hill



HTA Landscape Design

Cane Hill's green infrastructure connects a series of linked open spaces that bring together play, recreation and biodiversity within a unified landscape. Designed to encourage healthy, active living, it offers a sequence of spaces that cater to a wide range of users, from quiet contemplative gardens to more social, family oriented areas.

The new village green provides a social focus and a natural starting point for exploring the site's dramatic setting on the North Downs. From here, residents can follow a network of walking and cycling paths that wind through woodland, meadows and parkland before linking to Coulsdon Town Centre, the railway station and the surrounding countryside.







## Officers' Field

Dorset  
for ZeroC

Completed in 2012, Officers' Field delivers 77 sustainable homes at Osprey Quays on the Portland Peninsula. HTA Design led the masterplan and landscape design, creating a neighbourhood that responds to the coastal setting and historic context.

The scheme dedicates 40% of the site to public open space, including a central tree lined square with lawns, planters and stone paving for everyday use and local events. The landscape extends to a playing field, upgraded leisure centre, and an off site skate park, with improvements to nearby Victory Gardens reinforcing local connections.

A coastal palette of hardy native planting reflects the peninsula's character, supported by sustainable drainage features throughout. Originally designed as the Olympic and Paralympic Sailing Village, Officers' Field has since become a part of Portland's seafront.



Officers' Field

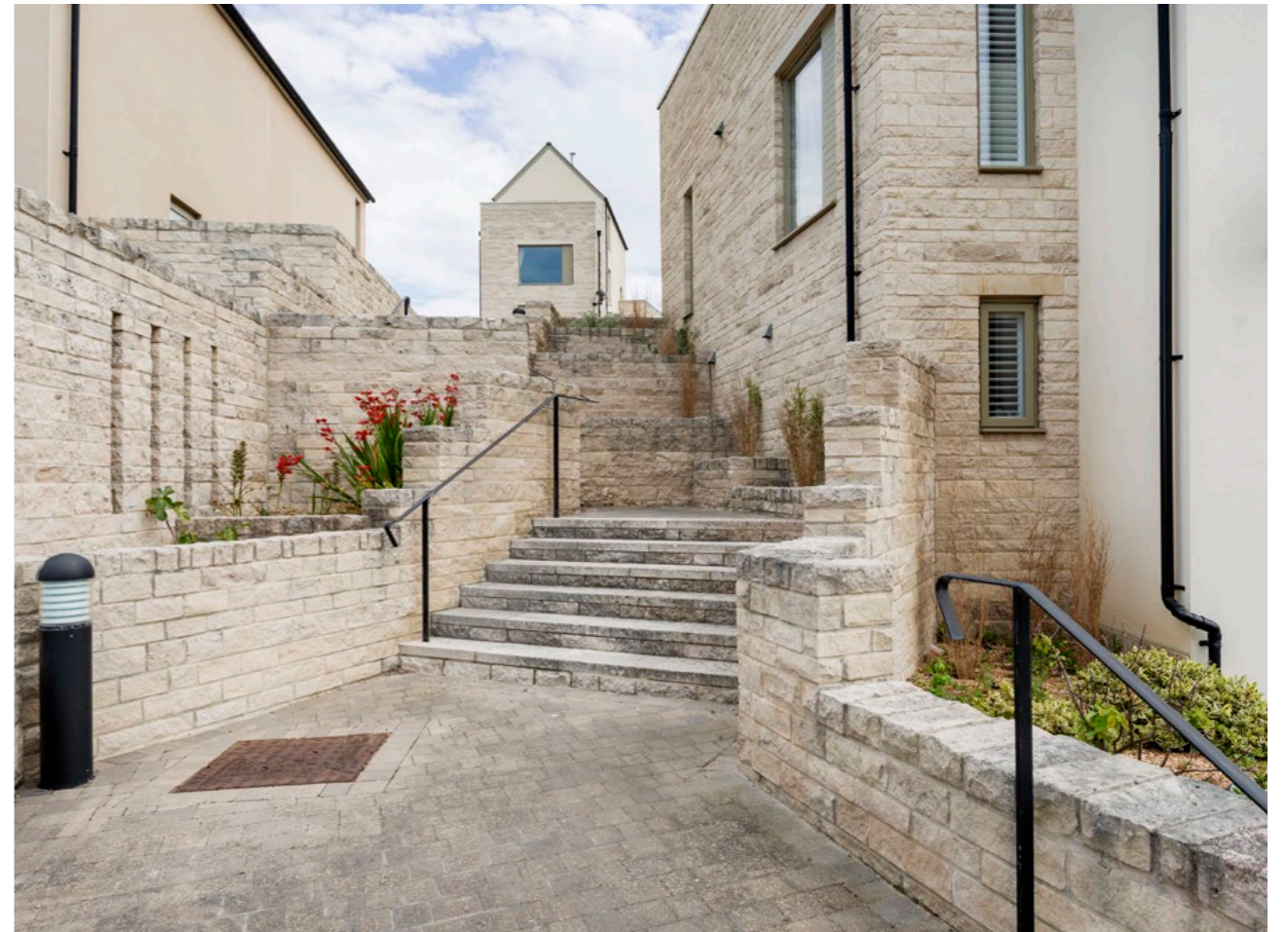

HTA Landscape Design



## Contact:



### James Lord

BA (Hons) MLA CMLI  
Partner, Landscape Design

**T:** +44 7790 067 538  
**E:** james.lord@hta.co.uk



### Oliver Rock

CMLI  
Associate Partner,  
Landscape Design

**T:** +44 7850 916 080  
**E:** oliver.rock@hta.co.uk



### Natalia Roussou

DipArch MLA ARB CMLI  
Senior Associate,  
Landscape Design Director

**T:** +44 7809 309 171  
**E:** natalia.roussou@hta.co.uk



### Mark Donaldson

MA (Hons) CMLI  
Senior Associate,  
Landscape Design Director

**T:** +44 7795 181 190  
**E:** mark.donaldson@hta.co.uk





hta.co.uk  
@htadesignllp  
landscape@hta.co.uk  
020 7485 8555

